

Acme Coke
11236 S. Torrence Ave.
Chicago IL 60617



acmecoke.com

Document archive

Napthalene Piping

Dated: 1978

Recovered from site on March 6 2021

PIPE NAPHTHALENE
TO DECANTERS
AT
CHICAGO COKE PLANT

SPECIFICATION NO. II-4223

February 22, 1978

INTERLAKE, INC.
10730 Burley Avenue
Chicago, Illinois 60617

1.00 INTRODUCTION -

This specification is written to define the scope of work to pipe naphthalene to the decanters at the Chicago Coke Plant located at 11236 Torrence Avenue.

2.00 SCOPE OF WORK -

The Contractor shall furnish all supervision, labor, and material, unless specified, for the following items of work, but shall not be limited to the wording of the items listed or done in the order listed.

- 2.01 Install concrete foundation for Tuthill Model 3A (7-1/2 HP) industrial pump mounted on steel baseplate. Interlake to furnish pump, assembly, and install electrical equipment. Contractor to set pump and grout.
- 2.02 Install suction piping at final cooler area per Sketch SKF-944.
- 2.03 Install 3 pump discharge line to the decanters. Provide necessary pipe supports.
- 2.04 Remove old line from naphthalene storage tank to the decanter.
- 2.05 Install 10" mixing pipe, 2" tar line, and 4" piping into the decanters per Sketch SKF-944. Include core drilling (2) holes through the 4" thick concrete roof.
- 2.06 Steam trace all new lines with 1/2" stainless tubing. Include three passes on the 10" pipe. Provide necessary traps.
- 2.07 Insulate all new piping and cover with aluminum jacketing.

3.00 GENERAL CONDITIONS -

- 3.01 The provisions of Specification IIC-1000, Standard General Conditions, shall apply as part of this Specification.
- 3.02 Scrap steel to be disposed of in Interlake's scrap pile.
- 3.03 Contractor to note field conditions and make all necessary field measurements.

4.00 ATTACHMENTS -

- 4.01 The following drawing is included in this Specification: SKF-944
- 4.02 The following standard specifications are included as part of the Specification and the provisions contained therein shall apply to this work:

- II-1000 General Conditions
- II-1401 General Piping
- II-1402 Piping Insulation

February 22, 1978

Specification to
Pipe Naphthalene to
Decanters at Chicago Coke Plant
Continued . . . Page 2

5.00 BID INSTRUCTIONS -

5.01 Bids must be submitted on the attached form.

5.02 Bids shall be returned within (7) days of the inquiry date.

5.03 Contact J. L. Bitner - Plant Engineer - for site inspection.
Telephone #312-221-3131, Extension 326.

JOB TITLE NAPHTHALENE TO DECANTERS

ENGINEER JLB
E. R. or PROJECT

PAGE
DATE 2/11/75

1/2" Ø VALVES	"	1/2" STG IN SE	(10) REQ
1" Ø VALVES	"	1" STG IN SE	(5) REQ
2" Ø VALVES	"	4 426 RT	(3) REQ
3" Ø PLUG VALVE	(1) REQ		
4" Ø PLUG VALVE	(2) REQ		
2" Ø PLUG VALVE	(2) REQ		

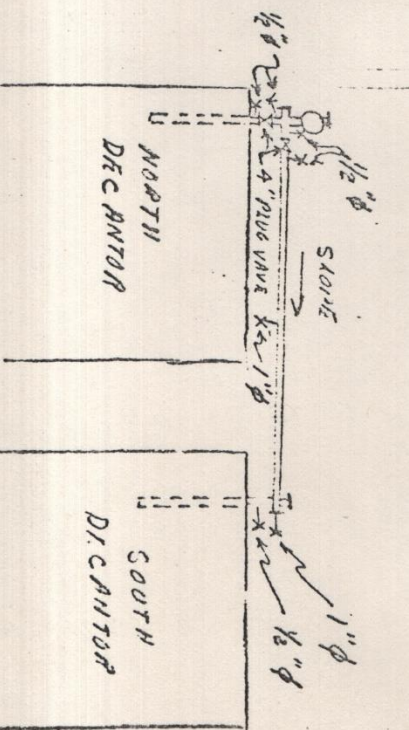
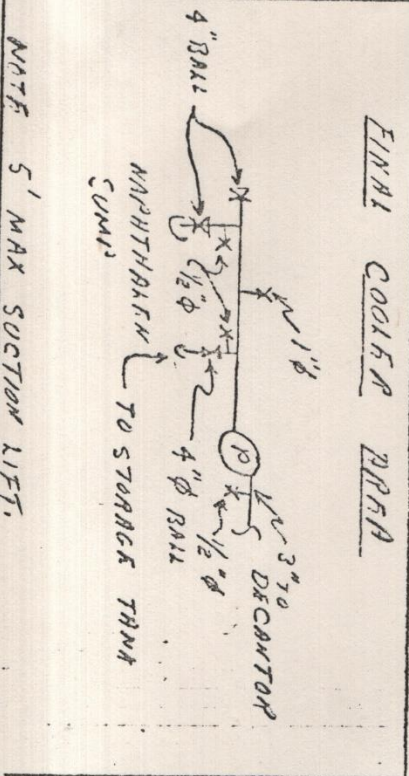
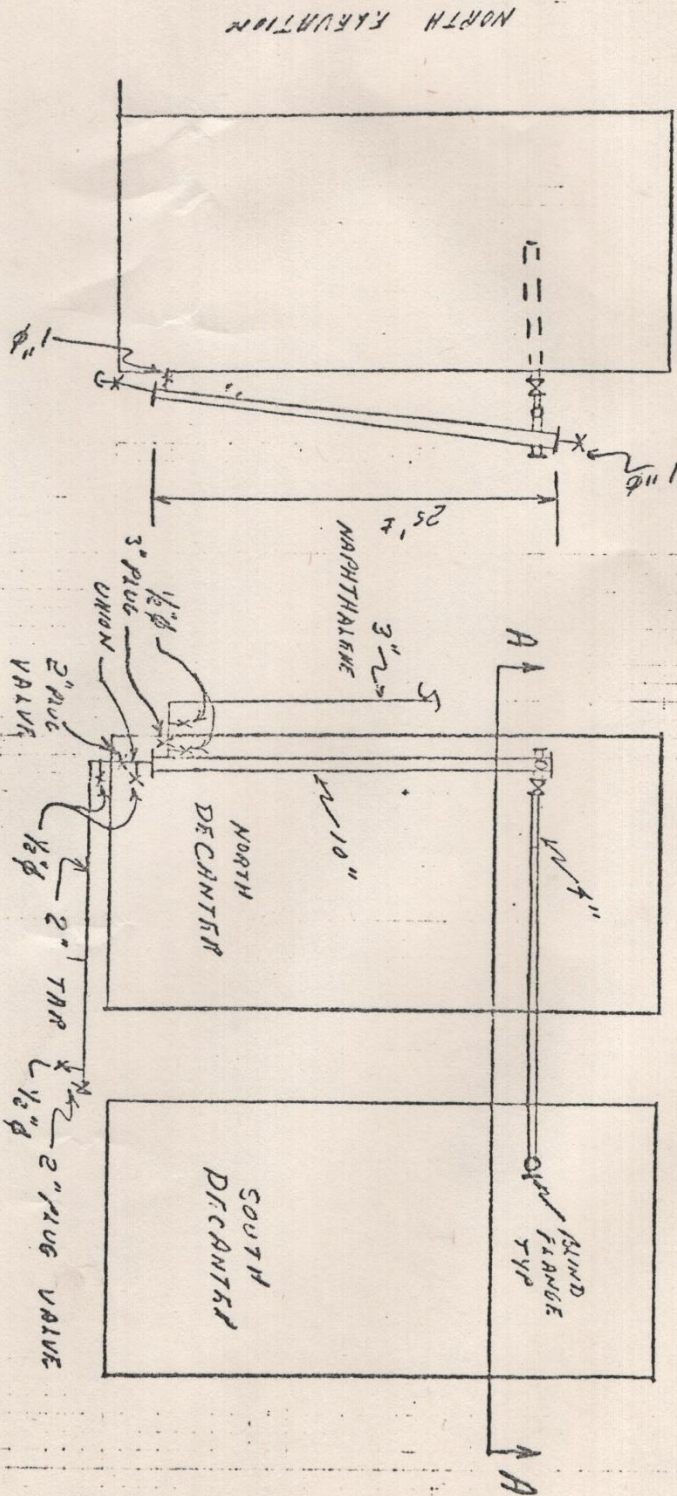

PUMP	Model	Construction	Print for
	Optional Equip		
DRIVE		Reducer Mtg	Order No
Class	Output RPM	Size	All-Motor <input type="radio"/> Integral <input type="radio"/>
Motor HP	Phase	Hz	Volts
Enclosure			RPM
			Frame
			Base
			Coupling
			Signed
			Date

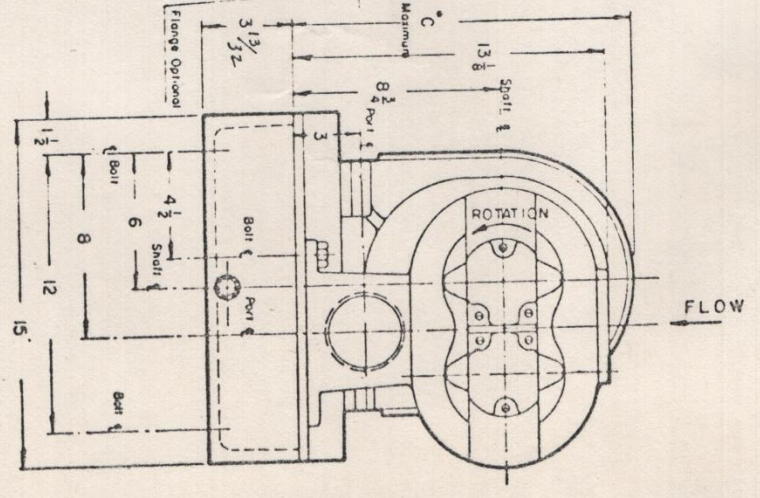
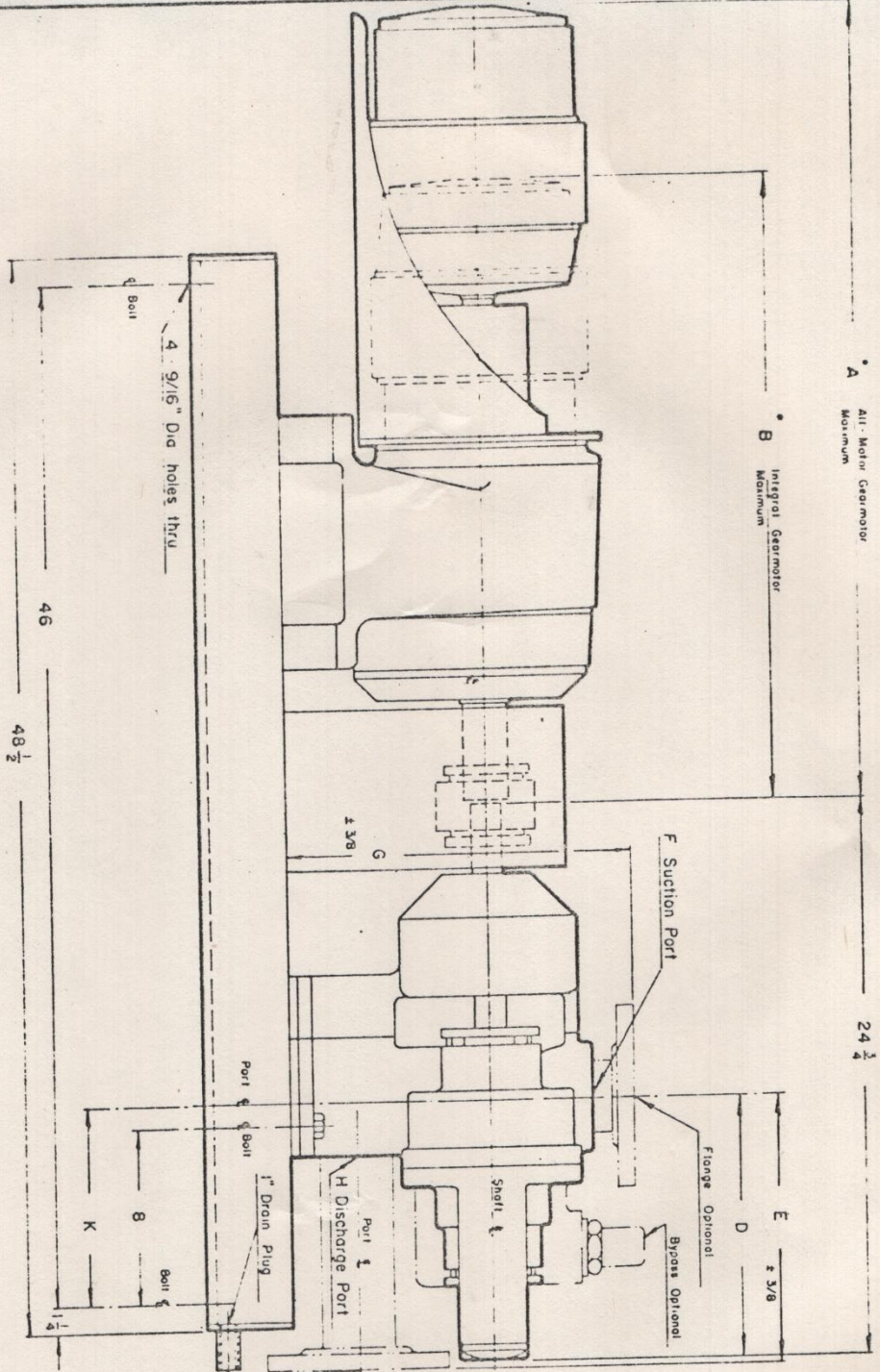

Dimensions A, B, C are controlled by the motor manufacturer. For the exact dimensions, motor certified dimension prints would be supplied.

A	B	C
---	---	---

Model	D	E	F	G	H	K
2A	10 1/8	11 1/16	2" NPT	14 11/16	2" NPT	7 1/2
3A	11	11 3/4	3" NPT	15	3" NPT	8 1/2

MARSHALL-BOND PUMPS, INC.
 5705 N. Lincoln Ave.
 Chicago, Illinois 60659

DATE: 2-25-76
 APPROVED BY: Rafterly
 DRAWN BY: Bond

Standard 2A B 3A Industrial Turbine Pump - Gearmotor Assembly Arrangement
 Tolerance ± 1/8" unless otherwise specified

300

5.00

The Undersigned has examined the location of the proposed work and is familiar with the local conditions as will affect the proposed work.

5.01 Names of Contractor Personnel and/or Subcontractor present at site of inspection _____

5.02 Names of Interlake Personnel present or contacted at Plant during site inspection _____

5.03 Exceptions or scope changes to Specification, Drawings, or Conditions noted at site inspection, included or excluded in the proposal price. (Be specific; if none, state none).

6.00 For the alternate of Interlake furnishing the 26 valves shown on SKF 944.

add - deduct the amount of \$ _____
to-from the stipulated price.

6.01 (for other alternate)

INTERLEAK, INC.
CAPITAL EXPENDITURE AUTHORIZATION SUMMARY

REHABILITATION

DIVISION - PLANT

Iron and Steel - Chicago

C-2970

C. E. A. NO.

TEMP. NO.

ITEM NO. - CAPITAL PLAN

Not listed

PROJECT TITLE

Purchase Naphthalene Pump

TOTAL CAPITAL AMOUNT IN CAPITAL PLAN:

PROFIT PLAN:

FIRST REVIEW:

SECOND REVIEW:

COMPLETION TIME

(MONTHS FROM APPROVAL) 4 Months

PROJECT SPONSOR

J. H. Merrill

CAPITAL FUNDS TO BE APPROVED:

Land	\$ _____
Buildings	_____
Equipment	<u>31,200</u>
Less: Cash value of facilities replaced	\$ _____
	<u>\$ 31,200</u>

DESCRIPTION AND JUSTIFICATION:

This project provides for the purchase and installation of a positive displacement pump and the necessary piping to allow the injection of raw naphthalene into the flushing liquor decanters. This will allow the naphthalene to be absorbed by the tar, improving its quality and eliminating a source of pollution the present naphthalene separation process creates due to the escape of noxious vapors. This will also result in increased tar volume and provide annual benefits of \$6,800.

TOTAL INVESTMENT:

Capital Funds	\$ <u>31,200</u>
Working capital	_____
Total	<u>\$ 31,200</u>

Currently, naphthalene is removed from the coke oven gas as a separate by-product and sold as such. This is accomplished by means of the final cooler system where naphthalene is washed from the gas and transferred to a steam heated pan. The naphthalene is then separated from the water by evaporation and then pumped to a holding tank.

JUSTIFICATION:

Discounted Cash Flow Return	<u>13.78%</u>	%
Payback Period	<u>6 Years, 2 Months</u>	

This proposal intends to install a pump and a 3" line to transfer the naphthalene slurry from the final cooler to the flushing liquor decanters. The naphthalene will be absorbed by the tar and the water will be separated and recycled to the final cooler.

RELATED EXPENSES:

Expense:	
Project	\$ <u>1,100</u>
Start-up	_____
Total	<u>\$ 1,100</u>

Justification of this project lies in its ability to improve tar quality and fluidity for easier handling. This proposal will also eliminate the use of the naphthalene heating pan which is exposed to the atmosphere and a source of pollution. Continued use of the present facilities will necessitate the construction of a dike at a cost of \$15,000 around the existing storage tank as directed by the Chicago Fire Department. Adoption of this proposal will eliminate the need for such a dike and avoid the associated cost.

APPROVED BY

TITLE

SIGNATURE

DATE

1. Vice President - Metals
2. Executive Vice President - Finance and Planning
3. President and Chief Operating Officer
4. Chairman and Chief Executive Officer
- 5.

DIVISION - PLANT

Iron and Steel - Chicago

C-2970

PROJECT TITLE

Purchase Naphthalene Pump

REVIEWED BY	SIGNATURE	DATE
Originator	D. T. Telle	3-16-78
Project Sponsor		
Plant Engineer	M. J. Brown	3/16/78
Plant Accountant	D. G. Cooper	3/17/78
Other Interested Parties	M. S. Smith	3-16-78
	G. J. [unclear]	3-17-78
	R. J. [unclear]	3-23-78
Department Head	J. H. [unclear]	3-27-78
Plant Manager		
Divisional Accounting Manager		
Works Manager		
Other Interested Parties		
President, Subsidiary		
Vice President - Engineering		
Controller		
Director Financial Planning and Control		

INTERLAKE, INC.

EXPENDITURE AUTHORIZATION

SCHEDULE A

DESCRIPTION OF PROJECT AND ALTERNATIVES CONSIDERED

PROJECT NO.

PROJECT TITLE		DIVISION-PLANT	
Purchase Naphthalene Pump		Iron and Steel - Chicago	
DEPARTMENT OR COST CENTER		BUILDING	FLOOR
C-2970	By-Products Apparatus		

This project provides for the purchase and installation of a pump and the necessary piping to allow the injection of raw naphthalene into the flushing liquor decanters. This will permit the naphthalene to be absorbed by the tar resulting in an improved tar quality and fluidity. The present naphthalene separation process will be eliminated, thus, reducing the existing pollution problems created by noxious vapors escaping into the atmosphere. Adoption of this proposal will not only eliminate a source of pollution, but will permit Interlake to avoid the construction of a retention dike surrounding the existing naphthalene storage tank as dictated by the Chicago Fire Department should this facility remain in operation. The cost of such a dike would approximate \$15,000. In addition to these benefits, the proposed method of naphthalene recovery will increase the tar volume and provide additional annual revenue of \$6,800.

Presently, naphthalene is removed from the coke oven gas as a separate by-product and sold as such. This is accomplished by means of the final cooler system where the naphthalene is washed from the gas by cooling water in a counter-flow tower. The product is then flotation separated from the cooling water in concrete collection bays to form a naphthalene water slurry. This slurry is transferred to a melting pan located on top of the naphthalene storage tank where it is exposed to the atmosphere and heated by steam coils to evaporate the water. The liquid naphthalene is subsequently stored in an insulated tank. This method results in an air pollution problem due to the escape of vapors during the melting process in the exposed heating pan, as well as, a safety hazard due to the vapors, the possibility of chemical burns, and the danger of fire.

On September 9, 1976, The Chicago Coke Plant was cited by the Chicago Bureau of Fire Prevention for not having a dike system around the 14,000 gallon naphthalene storage tank. The Chicago Fire Department considers liquid naphthalene to be a flammable liquid and, therefore, Interlake has been notified to comply with Section 129.1 of the City Code which states, "Provide an approved dike system capable of containing not less than one and one-fourth (1-1/4) times the combined capacity of the tank or tanks it surrounds". The associated construction cost of such a dike would be approximately \$15,000. The proposed recovery process would eliminate usage of this 14,000 gallon storage tank and negate the requirement of a dike.

This project proposes to install a pump and a 3" insulated and steam traced line to transfer the raw naphthalene slurry from the final cooler to the flushing liquor decanters where the naphthalene will combine with the tar. Absorption of naphthalene by the tar, which is presently 25% naphthalene, will dilute the tar and decrease the QI (Quinoline Insolubles) content per gallon resulting in a slight improvement in tar quality. Since the product will be absorbed by the tar and not melted in an open pan, the danger of air pollution is greatly reduced. In addition, the proposed pump is a variable speed unit and no storage of naphthalene will be required. The naphthalene will be mixed together with the tar in a large diameter mixing tube located adjacent to the decanters. This will allow most of the absorption into the tar to occur outside the decanters and prevent disruption of the decanting process.

INTERLAKE, INC.

EXPENDITURE AUTHORIZATION

SCHEDULE A

DESCRIPTION OF PROJECT AND ALTERNATIVES CONSIDERED

PROJECT NO.

PROJECT TITLE

Purchase Naphthalene Pump

DIVISION-PLANT

Iron and Steel - Chicago

DEPARTMENT OR COST CENTER

C-2970 By-Products Apparatus

BUILDING

FLOOR

Justification of this project lies in its ability to improve tar quality and increase its fluidity for easier handling. Use of the heating pan will be eliminated, minimizing the problem of air pollution due to escaping naphthalene vapors. Adoption of this proposal will permit the plant to avoid construction of a dike around the present naphthalene storage tank as directed by the Chicago Fire Department. Continued use of the present naphthalene facilities, which includes the storage tank, will necessitate construction of this dike at a cost estimated at \$15,000. In addition to these benefits, absorption of the naphthalene by the tar will increase tar production and the associated revenue by \$6,800 annually.

INTERLAKE, INC.

EXPENDITURE AUTHORIZATION
SCHEDULE B

CALCULATION OF EXPENDITURE REQUIRED
AND EXPENDITURE PAYOUT PERIOD

PROJECT NO.

PROJECT TITLE		DIVISION-PLANT			
Purchase Naphthalene Pump		Iron and Steel - Chicago			
SUB-ACCOUNT NUMBER	CHECK DIGIT NUMBER*	DESCRIPTION	EXPENDITURE AMOUNT		ACCOUNT DISTRIBUTION
			CAPITAL	EXPENSE	
			\$	\$	
50		Remove Old Piping		600 ⁽¹⁾	
100		Purchase Pump	4,900 ⁽²⁾		
200		Purchase & Install Piping	24,300 ⁽³⁾		
850		Taxes		500	
950		Contingency	<u>2,000⁽⁴⁾</u>	<u> </u>	
		TOTAL	<u>\$31,200</u>	<u>\$1,100</u>	

- (1) Based on a quotation from Commonwealth Mechanical Contractors, dated 3/9/78, Item 2.04
- (2) Based on a quotation from Marshall-Bond Pumps, Inc., dated 2/21/78.
- (3) Based on a quotation from Commonwealth Mechanical Contractors, dated 3/9/78, Item 2.04 (\$23,100); and Meade Electric Company, Inc., dated 12/19/77 (\$1,225).
- (4) Included to allow for unanticipated installation costs.

NOTE: No Engineering is required for this project.

Payout 2nd Qtr., 1978.

EXPENDITURE AUTHORIZATION

SCHEDULE C
PROJECT JUSTIFICATION

PROJECT NO.

PROJECT TITLE

DIVISION-PLANT

Purchase Naphthalene Pump

Iron and Steel - Chicago

DEPARTMENT OR COST CENTER

BUILDING

FLOOR

C-2970

Absorption of naphthalene by the tar will result in increased tar production. The value of an equivalent gallon of naphthalene sold as a tar product is greater than that as a separate by-product. The verifiable annual benefits are depicted below.

Increased Tar Production	82,834 gals/year @ \$.381 *	\$ 31,560
Less: Loss of revenue from naphthalene sales		
	82,834 gals/year @ \$.299 *	<u>(24,760)</u>
Net Benefits		<u>\$ 6,800</u>

Additional benefits will be derived from this project by eliminating the steam required to melt the naphthalene slurry. This steam usage is not metered and therefore cannot be quantified rendering these benefits non-verifiable.

* Based on 6/27/77 Standards

INTERLAKE, INC.

CASH FLOW STATEMENT

SCHEDULE C1

PROJECT TITLE
PURCHASE

NAPHTHALENE PUMP

PAYBACK PERIOD: 6.14 YEARS

TOTAL CUT	EARN BF T&D	LESS: DEPR	TAX EARN	INCOME TAXES	AFTER TAX	ADD DEPR	TOTAL INFLOW	NET FLOW	CUM NET FLOW
31200	-1100	0	-1100	-528	-572	0	-572	-31772	-31772
0	6800	2151	4648	-883	5537	2151	7688	7683	-24083
0	6800	4206	2793	1340	1452	4006	5459	5459	-13623
0	6800	3454	3345	1606	1739	3454	5193	5193	-13430
0	6300	2977	3822	1834	1987	2977	4965	4965	-8464
0	6300	2566	4233	2031	2201	2566	4768	4768	-3696
0	6300	2212	4587	2201	2335	2212	4598	4598	901
0	6300	1907	4392	2348	2544	1907	4451	4451	5353
0	6300	1644	5155	2474	2680	1644	4325	4325	9678
0	6300	1468	5331	2559	2772	1468	4240	4240	13919
0	6300	1468	5331	2559	2772	1468	4240	4240	18160
0	6300	1468	5331	2559	2772	1468	4240	4240	22400
0	6800	1468	5331	2559	2772	1468	4240	4240	26641
0	6800	1468	5331	2559	2772	1468	4240	4240	30882
0	6800	1468	5331	2559	2772	1468	4240	4240	35123
0	6800	1468	5331	2559	2772	1468	4240	4240	39363

INVESTMENT TAX CREDIT (PROJECT YDAR 1) = $31200 \times 10\% = 3120.0$

PROJECT COMPLETION TIME: 4 MONTHS

RECOVERY VALUE= 0

ASSET DEPRECIATED FOR 15 YEARS

03-16-78

INTERLAKE, INC.

CALCULATION OF DISCOUNTED CASH FLOW

SCHEDULE C2

PURCHASE

NAPHTHALENE PUMP

D C F = 13.78 % AFTER TAX

YEARS PRIOR TO START-UP	NET CASH FLOW	PRESENT VALUE	
		13%	14%
6 MOS TO 0	-31772	-32815	-32896
YEARS IN OPERATION			
1	7688	7207	7171
2	5459	4496	4430
3	5193	3759	3667
4	4965	3158	3050
5	4768	2664	2548
6	4598	2258	2133
7	4451	1921	1801
8	4325	1640	1522
9	4240	1413	1299
10	4240	1241	1130
11	4240	1091	983
12	4240	958	855
13	4240	842	744
14	4240	740	647
15	4240	650	563
RECOVERY	0	0	0
TOTAL	39363	1228	-339

03-16-78

PROPOSAL

RECEIVED

MAR 14 1978

To: J. B. BRUCE
3/14

PURCHASING

Bidder Commonwealth Mechanical Contractors

Bidder's Proposal No. _____ Date 3-9-78

RE: II Inquiry No. 13-181-78 Date 2-24-78

The following proposal is hereby made to Interlake, Inc.
10730 Burley Avenue, Chicago, Illinois 60617.

1.00 The Undersigned hereby proposes and agrees to furnish all the necessary labor, materials, equipment, tools, supplies, and services necessary for ~~the XXXXX to pipe naphthalene to decanters~~ at the Chicago Coke Plant all in accordance with Specification No. II 4223 dated 2/22/78, for the stipulated amount of \$ 23,657.00 based on straight time labor.

2.00 The Undersigned agrees to start field work within four calendar days after receipt of order and to proceed continuously to completion in twenty-one calendar days.

.00 The Undersigned agrees to furnish adequate competent supervision on the job site to insure expeditious progress and proper workmanship commensurate with the Contractor's responsibilities as outlined in the Specification.

.00 The proposed Contract Price includes all taxes and working permits.
An account breakdown is as follows:

2.01 to 2.03 - PIPING	\$ 11,400.00
2.04 - REMOVAL	640.00
2.05 - MIXING SYSTEM	4,467.00
2.06 - STEAM TRACE	1,550.00
2.07 - INSULATE	5,600.00

TOTAL \$ 23,657.00

23,100 - 200
1,200
21,300 ← TOTAL

880 N. YORK ROAD
ELMHURST, ILL. 60126
(312) 832-6333

UE

NO. 1005

DATE: February 21, 1973

F.O.B. Chicago, Illinois

TERMS: Net 30 Days

DELIVERY: 10 Weeks

TO

Mr. M.H. Harper, Mgr. of Purch.
Interlake, Incorporated
Chicago Furnace Plant
10730 South Lurley
Chicago, Illinois 60617

GENTLEMEN: THANK YOU FOR YOUR INQUIRY OF _____

NO. _____

WE ARE PLEASED TO QUOTE YOU AS FOLLOWS:

QUANTITY	DESCRIPTION	PRICE
ONE (1)	<p><u>APPLICATION:</u></p> <p>Product: Napthalene Crystals & Water Capacity: 5-50 GPM Viscosity: Water Thin Temperature: Ambient Specific Gravity: 1.0 Suction: 5 Ft. Suction Lift Discharge: Approximately 100 PSI</p> <p><u>RECOMMENDATION:</u></p> <p>Tuthill Model 3A Industrial Pump in cast iron construction throughout the fluid chamber. Mounted on a fabricated steel baseplate and direct driven through a guard enclosed flexible coupling by a 7-1/2 HP 3PH 60 HZ/230-460 V/245-24,5 RPM Class 1 Group D explosionproof Reeves Motodrive with manual speed control.</p> <p>CC: Mr. James Pitner Interlake, Inc. Chicago Coke Plant 11236 So. Torrence Chicago, Ill. 60617</p> <p>(This quote updates previous Quote #927 as to current pricing for same item originally quoted)</p>	<p>\$ 4,863.00 NET EACH</p> <p><i>acc'd #100</i></p>

We shall be pleased to supply any further information you may desire and trust that you will decide to favor us with this order which will receive our prompt and careful attention.

Per Karen Riddley

PROPOSAL

L.C. KOHLMAN INC.

Contractor's Proposal No. _____ Date 3/7/78

II Inquiry No. 13-181-78 Date _____

The following proposal is hereby made to Interlake, Inc.
10730 Burley Avenue, Chicago, Illinois 60617.

The Undersigned hereby proposes and agrees to furnish all the necessary labor, materials, equipment, tools, supplies, and services necessary for ~~the installation of~~ to pipe naphthalene to decanters

at the Chicago Coke Plant

all in accordance with Specification No. II 4223

dated 2/22/78, for the stipulated amount of \$ 35,250.⁰⁰

based on straight time labor.

The Undersigned agrees to start field work within _____ calendar days after receipt of order and to proceed continuously to completion in _____ calendar days.

The Undersigned agrees to furnish adequate competent supervision on the job site to insure expeditious progress and proper workmanship commensurate with the Contractor's responsibilities as outlined in the Specification.

The proposed Contract Price includes all taxes and working permits.
An account breakdown is as follows:

2.01 to 2.03 - PIPING	\$ 21,407. ⁰⁰	net 200
2.04 - REMOVAL	1,266. ⁰⁰	net 50
2.05 - MIXING SYSTEM TUBE	2,705. ⁰⁰	200
2.06 - STEAM TRACE	546. ⁰⁰	" "
2.07 - INSULATE	641. ⁰⁰	" "

TOTAL

\$ 35,250.⁰⁰

MEADE ELECTRIC COMPANY, INC.

5401 W. HARRISON STREET
CHICAGO, ILLINOIS 60644
312 - 378-2800

INDUSTRIAL
& COMMERCIAL
CONSTRUCTION

MOTORS, MAGNETS,
MACHINE REPAIRS
& ELECTRONICS

PROPOSAL

Submitted to: Interlake, Inc.

Job Location Chicago Coke Plant

Address 10730 S. Burley Avenue

Job Name Napthalene Pump

City Chicago, State Ill. Zip 60617

Date December 19, 1977

Attention of: Mr. J. Bitner, Plant Engineer

Proposal binding ~~xxx~~ to 5/31/78

Meade Ref. #77-500-76

Our proposal is as follows:

Electrical installation of the Napthalene Pump.

We propose to furnish the necessary labor and material for the sum of

ONE THOUSAND TWO HUNDRED TWENTY FIVE & 00/100 DOLLARS (\$ 1,225.00)

MEADE ELECTRIC COMPANY, INC.

By Stanley J. Ignarski

Stanley J. Ignarski

Acceptance of this proposal;

By _____

Company

Date

Purchase Order No. _____

Contract No. _____

By _____

Signature of authorized personnel



TELEPHONE
L-7555

CITY OF CHICAGO
FIRE DEPARTMENT

BUREAU OF FIRE PREVENTION
COMPLIANCE BOARD

7974 South Chicago Avenue
CHICAGO, ILL. 60617

RICHARD J. DALEY
Mayor

ROBERT J. QUINN
Fire Commissioner

Interlake Inc.
John Seaman Supt.
10730 S Burley
Chicago, IL 60617

Re: Violation notice mailed to you at above address on 9-30-76

Premises: 11236 S Torrence

A recent reinspection of the above premises indicates that you have disregarded notices previously sent by the City of Chicago concerning violations of the Municipal Code.

You are hereby given an opportunity to explain your failure to comply with the Municipal Code. Failure to respond will result in a suit being started against you.

Compliance Board Hearing Will Be Held At:

7974 SOUTH CHICAGO AVENUE

Date November 16, 1977 at 9:00 a.m.

Violations of Municipal Code:

ITEM(S) 2

Your attention is directed to penalty provisions of the Municipal Code which provide for a maximum fine of Two Hundred Dollars (\$200.00) each day that the violation exists.

FURTHER INFORMATION REGARDING THIS NOTICE WILL BE AVAILABLE WHEN YOU APPEAR AT THE COMPLIANCE BOARD ON THE ABOVE DATE.

FOR THE COMPLIANCE BOARD

BY: _____

BRING THIS NOTICE WITH YOU

CITY OF CHICAGO
Bureau of Fire Prevention
444 No. DEARBORN ST.
CHICAGO, IL. 60610



Common Sense Prevents Fires and Accidents

RICHARD J. DALEY
Mayor

ROBERT J. QUINN
Fire Commissioner

INTERLAKE INC
JOHN SEAMAN SUPT
10730 S BURLEY
CHICAGO ILL 60617

DATE OF NOTICE 09/30/76
WIDTH 10' LENGTH 25' HEIGHT 10
FLOOR NO. _____ ROOM NO. _____ BLDG. NO. 0008
CONSTN _____ BADGE NO. 163
1101 STRUCTURE
NAPHTHALENE

You are hereby notified as owner, agent, lessee or occupant of the structure located

at 11236-11236 S TORRENCE

to comply with the Municipal Code of Chicago within 15 days (except as noted) as follows:

- 925-01 SEC. 129.1-3 PAINT THE WORDS 'FLAMMABLE-KEEP FIRE AWAY' ON STORAGE TANKS OF FLAMMABLE LIQUIDS. PAINT THESE WORDS IN RED ON A WHITE BACKGROUND WITH EACH LETTER AT LEAST SIX(6) INCHES HIGH AND THREE QUARTER(3/4) INCHES WIDE.
- 960-02 SEC. 129.1-14, 43-1, 43-4 PROVIDE AN APPROVED DIKE SYSTEM CAPABLE OF CONTAINING NOT LESS THAN ONE AND ONE FOURTH (1 1/4) TIMES THE COMBINED CAPACITY OF THE TANK OR TANKS IT SURROUNDS. SUBMIT PLANS TO AND OBTAIN PERMIT FROM THE BUILDING DEPARTMENT BEFORE STARTING WORK.

A

*Flamm paint
below 200° a of
condition - to contain burning
flammable liquid*

*14,200 gal
10*

FOR FURTHER INFORMATION PERTAINING TO THE ABOVE VIOLATIONS, CALL AREA OFFICE: 221-7555

NOTE: FAILURE TO COMPLY WITH THIS NOTICE WITHIN THE AFORESAID TIME WILL RESULT IN SUCH ACTION AS THE LAW PROVIDES.

ved:
PLG

Robert J. Quinn

Francis J. Murphy

Director in Charge